



edvision

User Guide

QUICK START GUIDE

- 1** Please ensure SD card is inserted securely into the SD card slot before you start charging your GoVision glasses.
- 2** Please fully charge your glasses before use to ensure high quality video and still photography.
- 3** Glasses are fully charged when solid red light is off.



LENS CHANGING GUIDE

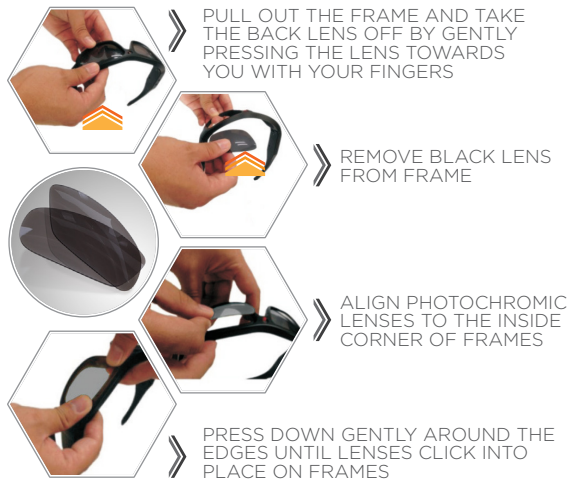

PolarizedMax Lens Coating Technology

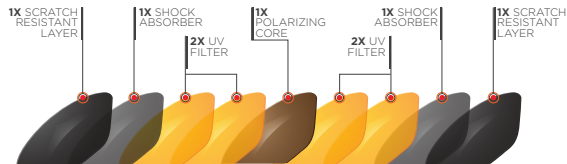

GOVISION

HD VIDEO RECORDING SUNGLASSES

GoVision is a brand of action camera sunglasses that allows users to capture their life-seeking adventures in high definition video/photography.

High definition polarized lenses offer highest available light reduction UV 400 protection for brilliant color enhancements and clarity. Image and recording life's adventures just got more stylish.

ONE TOUCH OPERATION



SIMPLY SHARING



GOVISION PRODUCT PREVIEW

1. On/Off/Pause Video Recording Button
2. Camera Button
3. LED power light indicator
4. Microphone
5. Camera Lens
6. Micro SD card slot
7. Reset Button
8. 8 pin USB port



USER GUIDE

■ ON/OFF

Press the on/off button to turn GoVision on and the LED light indicator will turn red. GoVision will automatically enter video record mode once the glasses have been tuned on and the red light begins to flash. To power off the glasses, hold down the on/off button for 3 seconds. The glasses will automatically save the video file and shut down.

■ RECORDING VIDEO

Power on the glasses by pressing the on/off button. Once powered on the glasses automatically enter into video record mode. To stop recording, press the on/off button. The LED light indicator will stop flashing and turn solid red. The system will automatically save video files in 10 minutes increments.

In order to ensure good sound quality, make sure you do not block the microphone. The glasses have a 3 minute shut off when not in record mode.

■ TAKING PICTURES

When the glasses are powered on, stop the video recording by pressing the on/off button. The glasses will enter into camera mode when the LED light indicator is solid red. Press the camera button once to take pictures and save images. The glasses have a 3 minutes shut off if a picture is not taken within this time frame.

- **Note: Make sure there is adequate light when taking pictures and the glasses are upright and stable.**

■ FILE UPLOADS

Connect the GoVision Sunglasses with the USB cable to a proper computer USB port. The sunglasses will be recognized in the Removable Disk Drive Folder. All of your movies and photos can be accessed in the file folder DCIM.

- **Note: Please allow time for your computer to discover the glasses USB cable in the removable disk drive when looking to view video and photo files. If the USB cable is not identified after 2 minutes, ensure the 8-Pin end of the cable is properly secured to the glasses, then remove the USB cable and re-insert all the way into the computer.**

■ CHARGING

Connect glasses to computer by USB cable to charge battery. The red light will be solid red during the charging process. Glasses are fully charged when the red light is off. It will take up to 3 hours to obtain full charge. A high capacity lithium polymer battery powers GoVision. Please make sure your GoVision is fully charged before use.

USER GUIDE

■ HOW TO FORMAT MICRO SD CARD

If your GoVision glasses are on and your indicator light stays solid red for 1 minute and shuts off automatically the SD card must be formatted.

WINDOWS

- Go to My Computer
- Go To Removable Disk Drives
- Make sure your cursor is over the drive that holds the GoVision Glasses (ex: Removable Drive E)
- Right click
- Go to format
- Click on it
- A box will appear asking to format
- Click start

MAC

- Open the Applications Folder
- Select Utilities
- Click on Disk Utilities
- Click on the Untitled Folder on the left pane of disk utilities
- Select quickly
- Click on erase

■ TROUBLESHOOTING

INSUFFICIENT MICRO SD CARD STORAGE SPACE

Blue light will flash for 5 seconds and turn off. If this happens, please move the files off the SD card and store the files into a remote hard drive or on your computer to free up the SD card storage.

LOW BATTERY

When the glasses are in low battery status, the blue light will flicker and turn off. Please recharge your device.

NO FUNCTION

Please make sure the SD card is properly secured in the SD card slot.

If the glasses stop working for any reason or are not responding, please insert a small paper clip end into the reset button to restart device. If additional problems persist, please email us at customerservice@audyglobal.com or call our customer support line at 617.379.0023

TECHNICAL SPECS

Video Format:	AVI
Video Encoding:	M-Jpeg
Video Resolution:	1440*1080 @ 30fps
Video Frame rate:	30 fps
Camera Lens Sensor:	5MP OV CMOS Sensor
Media playing software:	Windows Media player or mainstream audio and video media playing software, KM Player recommended
Picture Format:	JPEG
Picture Pixels:	(4480 x 3360) 15 MP
Video Ratio Image:	4:3
Supporting systems:	Windows ME/2000/XP/2003/Vista/7, 8, 8.1, 10 and Mac OS 10.4 or higher
Interface type:	USB 8 pin Port
Storage support:	Micro SD (TF 10 Card) Max to 32gb
Battery type:	650mAh high-capacity lithium polymer
Battery charge time:	Approximately 3 hours by standard computer

WARNING

1. **Application:** Please strictly abide to all relevant State and Federal regulations and laws as it relates to video and photo recordings. This product should not be used for any illegal purposes. The user is fully responsible for all videos and photos captured.
2. **Battery:** If you have not recorded video for a long time, please charge your GoVision fully before using.
3. **File Security:** This product is not a professional storage device. It does not guarantee the integrity and security of saved files. Please back up your important documents on the computer or other storage device timely.
4. **Operating temperature:** 0–40°C. For the extension of life, it is best used at room temperature.
5. **Operating humidity:** 20%-80%. This product is not waterproof, avoid exposing to wet conditions, such as rainy conditions or being splashed.
6. **Shooting brightness:** Do not stare directly into sunlight to avoid damage to built-in optical device and your eyes.
7. **Cleaning:** Do not use in an environment with high dust density such as deserts or beaches to avoid damaging the camera lens or other components.
8. **Night time driving:** Not suitable for driving in twilight or at night or under conditions of dull light.
9. **Additional Eyewear:** Some activities may require glasses support straps or protective eyewear in addition to the GoVision HD Sunglasses.

WARRANTY

GoVision products and accessories are guaranteed against manufacturing defects for a period of one (1) year from the original date of purchase. GoVision's sole obligation in the event of a defect during this period is to repair or replace the defective part or product with a comparable part or product at GoVision's sole discretion. Except for such repair or replacement, the sale, processing or other handling of this product is without warranty, condition or other liability even though the defect or loss is caused by negligence or other fault. Damage resulting from use, accident, or normal wear and tear is not covered by this or any warranty. GoVision assumes no liability for any accident, injury, death, loss, or other claim related to or resulting from the use of this product. In no event shall GoVision be liable for incidental or consequential damages relating to or resulting from the use of this product or any of its parts. Returns or replacements of parts and/or products may be subject to shipping, handling, replacement and/or restocking fees.

Your Questions and Comments? Look no further than our Support Team for world class customer support, please email customerservice@audyglobal.com. We are here to help you with your GoVision product. We want you to like it as much as we do!

Please shop www.govisionusa.com for all new products and accessories



Designed and Distributed by **Audy Global Enterprises, Inc.**
+1.617.379.0023 | customerservice@audyglobal.com